

# MIZCO



mizco.com

## POWER BANKS

re-fuel® power and audio products are built to complement an action-packed lifestyle. As a leader in the power accessories market, re-fuel is the brand trusted and relied on to supply the battery life expected – and needed – to take devices the extra mile. Every item is fully vetted to make sure that it meets the performance standards and quality our customers come to expect from the re-fuel brand. With re-fuel power banks, athletes and athletes at heart can go the distance without stopping to recharge.

## POWER BANKS



### **The Adventurer** 10400mAh

For the adrenaline junkie who makes home videos of their best runs, greatest adventures and longest hikes. Charge up to two devices simultaneously. This battery pack will keep all your gear running all day long.



### **Go Charger power bank and GoPro® battery recharger**

For the GoPro enthusiast, this all-in-one power bank lets you charge up to two GoPro Hero4 batteries at the same time. It also comes with a USB port to charge your phone while charging your GoPro Hero4 batteries. Charge your GoPro without removing your battery by plugging it directly into the power bank's USB port.

### **The Weekender** 5200mAh

Made for the weekend warrior, The Weekender 5200mAh power bank will keep your phone up and running for those long trips away from home.



### **Grab N' Go family pack**

Share the power with friends and family. The Grab N Go comes with three 2600mAh power banks and a charging dock. Recharge your phone and stay connected all day long.



## THE FASTEST WAY TO CHARGE YOUR DEVICES

Mizco products with *InstaSense* adjust the flow of electricity to deliver the fastest and safest charge to connected devices. Charging products with *InstaSense* can recognize how much power your device draws and can automatically deliver exactly how much your smartphone or tablet needs to charge rapidly and safely.

Each Digipower product with *InstaSense* has built-in advanced protection to safeguard against overcharging and short-circuiting.



### USB Wall & Car Chargers

*Take the guesswork out of compatibility!*

Digipower Dual Port USB Wall & Car Chargers provide the fastest charge possible and are compatible with all mobile devices. Featuring 2.4A or 3.4A models and extra-long micro USB and Lightning™ cables.



### Four-Port USB Wall & Car Travel Chargers

*Charge everything you need in one place!*

The Digipower Four-Port USB wall and car chargers are compatible with all mobile devices.



### Charge & Sync Power Cables

*High-performance cables for superior charging*

Digipower Charge & Sync Cables offer features such as tangle-free cables, extra-long cords, heavy gauge wires, and multiple, simultaneous device-charging capability.

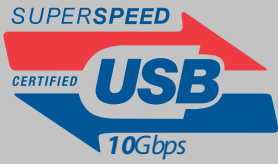

USB Type-C is rapidly becoming the new power and connectivity standard. However, it is not just a different type of charging port – it's a universal standard that works for all devices, including smartphones, tablets, laptops, and more.



## TYPE-C™



Digipower cables are some of the first in the industry to be certified by the USB Implementers Forum, guaranteeing superior construction and maximum performance. Digipower Type-C charging accessories are precisely manufactured to meet USB-IF specifications and strict testing requirements.



## WI-FI SECURITY CAMERA

The Digipower Smart Home series allows you to stay connected to your home from anywhere in the world.

Products in the Digipower smart home line include security cameras, motion sensors, smart plugs, window contacts, and wi-fi gateways, all operated through the Digipower Smart Home app.



### Security Camera

- 720P HD camera
- No installation fees
- No monthly charges
- Simple "DIY" setup
- Infrared sensor for night vision
- Control remotely from anywhere in the world



Digipower Smart Home App available on:



## SMART HOME

SH-IC5



HD Recording – 720p HD quality video recording puts you right in your bedroom or living room so you can keep an eye on your home.



Wi-Fi – Wirelessly connect this webcam to your internet connection to view footage from your phone.

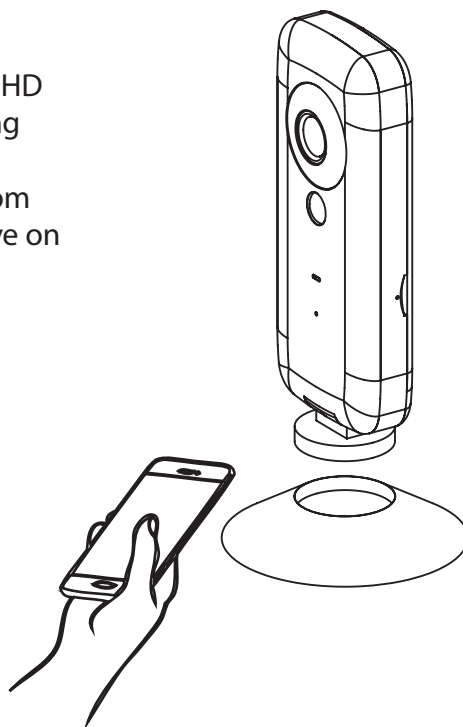

Stay Connected – Download the free app on your Smartphone or tablet to wirelessly stream live video footage.



Infrared Sensor – The camera will stay alert when you're not around with an infrared sensor alarm that detects movement.



## Police Camera

DPS-PC1A

### FEATURES

- IP68 Water proof & dust-proof
- Shock & Corrosion protection, 2M drop testing
- 2" high definition LCD
- 170 degree wide angle lens
- 15 meters IR night vision available range
- 1080P high definition video recording
- 32G built-NAND flash memory
- Compatible with most current two-way radio devices being used by law enforcement.

### SPECIFICATIONS

- Sensor: 5Mega CMOS sensor
- LCD: 2.0" High definition panel
- Lens: 170° wide angle lens
- Speaker: Built-in
- Microphone: Built-in
- USB: High speed USB2.0

#### Photo

- Output pixel: 5 Mega Real pixels, 8Mega & 16Mega by software interpolation
- Image resolution: 3200 x 2400 (8M) 4608 x 03456(16M)
- File format: JPEG
- File Qty: 4500 pcs

#### Video/Audio

- Video resolution: FHD: 1920 x 1080 (30fps)(default), HD: 1280 x 720 (60fps), D1: 720 x 480 (30fps)
- Video (compression) format: MP (H.264)
- Continuous video recording Time: 9.5-10hours(D1), over 8 hours (HD30), over 6hours (FHD)
- Audio compression format: AAC
- Continuous audio recording time: 11-12 hours

#### Operation/UI

- Night-vision distance: Strengthen energy-saving IR LED with 15 meters vision
- IR switching way: Auto or (by button)

#### Power supply

- Battery: 3000mAh
- Recharging time: in 6 hours
- Standby time: over one week



## Data Acquisition Station

DPS-DAS

### FEATURES

- Multiple devices simultaneously accessing
- Auto data importing
- Important photo issued
- Auto data upload cloud
- Software upgrade
- Strong compatibility
- Auto recognition
- Auto data emptying
- Equipment management and local data inquiry
- Remote data inquiry, playback and data download

### SPECIFICATIONS

#### Configuration

- 2TB-16TB optional, extended to 32TB
- 19 inch LCD with resolution 1280\*1024
- IR touch screen

#### Software & operation

- Windows 7 32Bit
- Police Cloud Management System

#### Police Management system outstanding features:

- Cloud server centralized storage
- BS architecture, auto upload information
- Auto data archiving, upload to server, auto archiving according to the format, time, user information file.
- Auto generation of statistical reports according to time and important level.
- Flexible user classification, authorization and system management.
- Setting of task plan, storage period and auto file upload to cloud server.
- Evidence recovery management, data backup management, to ensure the data security.





# THE NEW STANDARD IN TOUGH... THE TOUGHTESTED® PRO CABLE

- 50% Stronger
- Chemical/Heat/Abrasion resistant
- Aluminum Easy-fit Tip (fits most protective cases)
- Newly Designed Strain Relief
- Reversible Tip
- 5 Year Warranty
- Micro/Lightning/3.5mm Aux

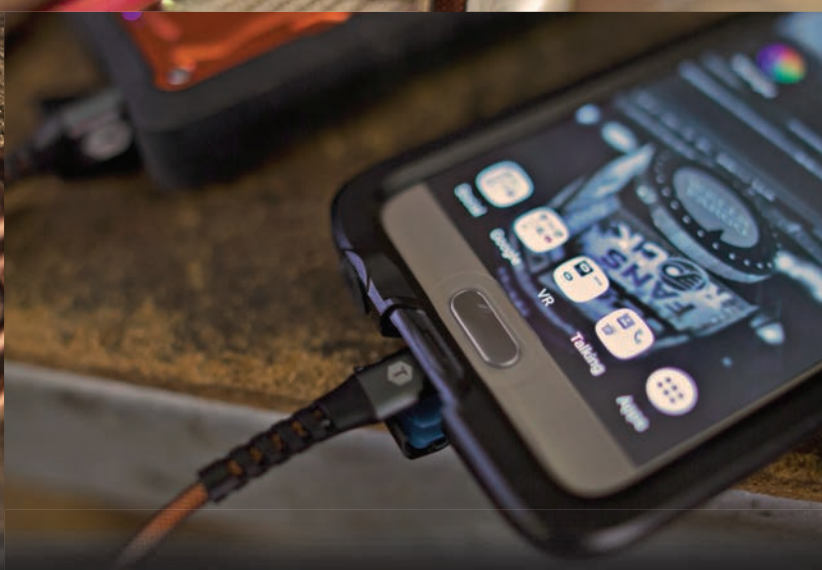

[www.facebook.com/toughtested](https://www.facebook.com/toughtested)



[@ToughTested](https://twitter.com/ToughTested)



[@madetogotowork](https://www.instagram.com/madetogotowork)



[toughtested.com](https://toughtested.com)



